

NATIVE SHADE TREE APPLICATION

PLANTING NATIVE TREES ENHANCES OUR COMMUNITY AND SONORAN DESERT ECOSYSTEM

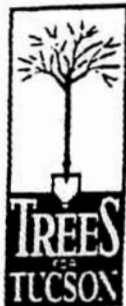

In partnership with



Thanks to a grant from **TUCSON ELECTRIC POWER COMPANY**, TEP customers may be eligible to receive 1 or 2 five gallon sized trees (3 - 6 ft. tall) for only **\$6.00 per tree including delivery (PAYABLE TO TREES FOR TUCSON - ATTACH CHECK)** if you agree to plant them to shade your house. Large shade trees can reduce cooling bills, especially if they shade windows or air conditioning units. Supplies are limited.

To qualify, each resident

A) Agree to plant trees within 15 of the house on the WEST, EAST, or NORTH sides to shade it from the rising and setting sun during the summer months, but retain access to direct winter sun/heat on the south side in the winter months. Planting location will be checked when trees are delivered. **Planting and maintenance instructions are provided with trees.**

B) Agree to hold Trees for Tucson and Tucson Electric Power Company harmless from all liability associated with the trees or tree planting.

Name: _____ Phone: _____ (H) _____ (O)

Address: _____ Zip Code _____

Indicate Your Native Tree Choice(s) [total of 2 trees per house] - all trees below are low water users:

- Velvet Mesquite (*fast/moderate growth rate to 20' + tall & wide, semi-winter deciduous, yellow flowers*)
- Desert Ironwood (*moderate growth rate to 20' tall and wide, evergreen, plant in warm microclimate, purple flowers*)
- Blue Palo Verde (*fast/moderate growth rate to 20+ ' tall and wide, blue-green leaves and bark, yellow flowers*)
- Foothills Palo Verde (*moderate growth rate to 20' tall and wide, yellow-green leaves and bark, yellow flowers*)
- Desert Willow (*fast growth rate to 20' tall and wide, winter deciduous, no thorns, purple/white flowers*)
- Cat Claw Acacia (*moderate growth rate to 20' tall and wide, winter deciduous, grey bark, yellow flowers*)
- White Thorn Acacia (*moderate growth rate to 15' tall and wide, winter deciduous, red bark, yellow flowers*)

(Signature of Resident)

(Date)

YOU MUST COMPLETE THIS SKETCH TO QUALIFY:

\$6.00 per tree
handling fee
payable to
Trees for Tucson

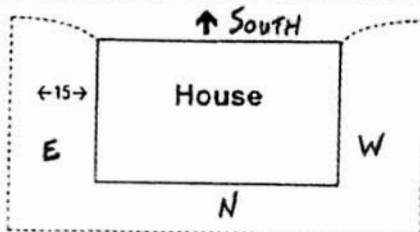

IMPORTANT:
Mark with an **X** where
you will plant trees in the
Planting Zone.

NOTE: Before you plant, call Blue Stake 1-800-782-5348 to mark all underground utilities for free. Plant trees at least 10 ft from sewer lines, 5 ft. from water lines, and 3 ft. from all other utilities. Do not plant under any overhead utility lines. Do not plant in the public right-of-way without a permit and Blue Stake clearance. Plant trees at least 20 ft. from one another.

Send Applications To: **TREES FOR TUCSON** P.O. Box 27210 Tucson, AZ 85726-7210 791-3109
Trees for Tucson is a program of Tucson Clean & Beautiful

ARE YOU INTERESTED IN OTHER TREES FOR TUCSON PROGRAMS?

Tree Care Workshop (free!) _____ Tucson and Southern Arizona Tree Tour - Fall/Spring (includes lunch and transportation) _____